

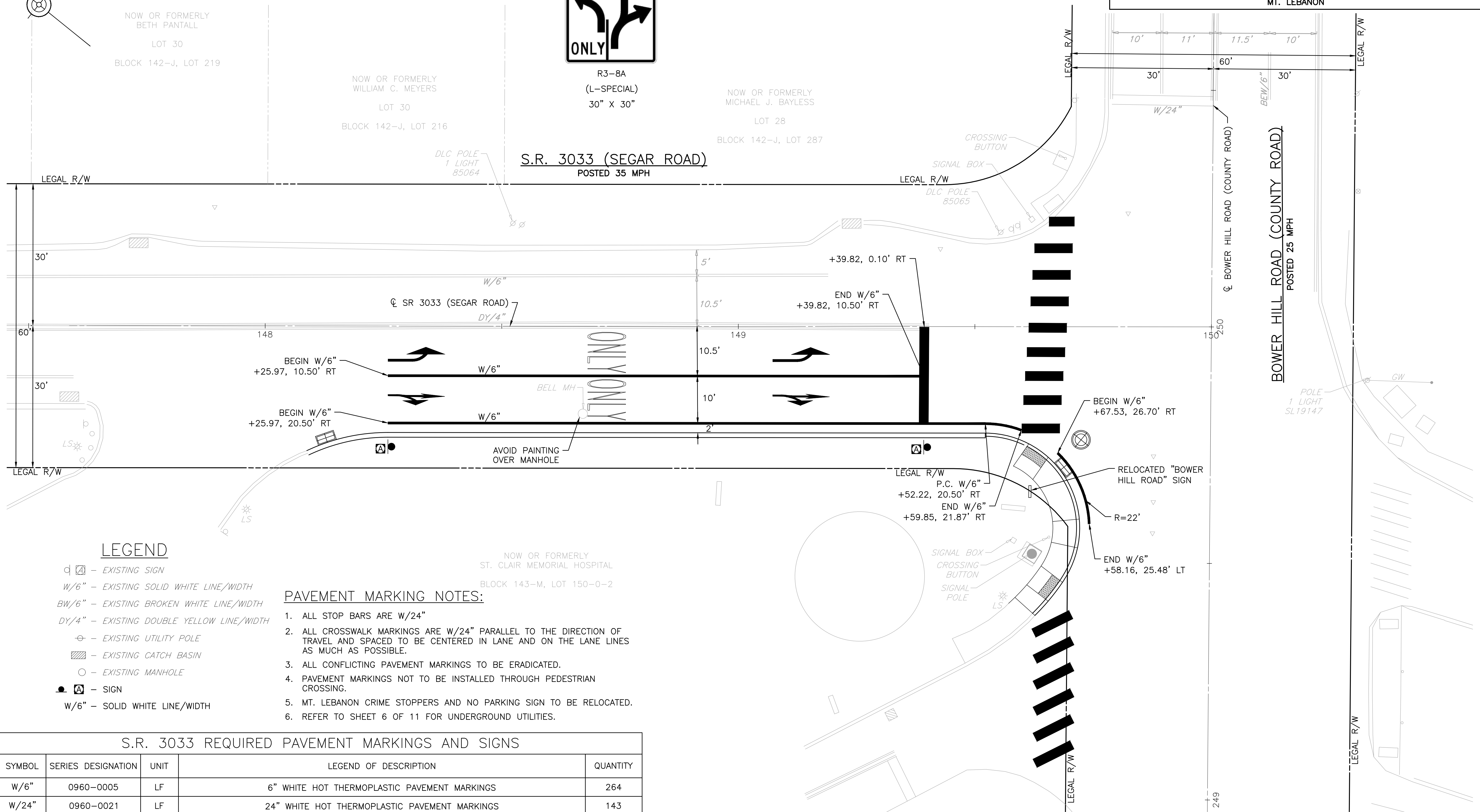

R3-8A  
(L-SPECIAL)  
30" X 30"

**S.R. 3033 (SEGAR ROAD)**  
POSTED 35 MPH



**LEGEND**

- ⓐ - EXISTING SIGN
- W/6" - EXISTING SOLID WHITE LINE/WIDTH
- BW/6" - EXISTING BROKEN WHITE LINE/WIDTH
- DY/4" - EXISTING DOUBLE YELLOW LINE/WIDTH
- ⊕ - EXISTING UTILITY POLE
- ▨ - EXISTING CATCH BASIN
- - EXISTING MANHOLE
- ⓐ - SIGN
- W/6" - SOLID WHITE LINE/WIDTH

**PAVEMENT MARKING NOTES:**

1. ALL STOP BARS ARE W/24"
2. ALL CROSSWALK MARKINGS ARE W/24" PARALLEL TO THE DIRECTION OF TRAVEL AND SPACED TO BE CENTERED IN LANE AND ON THE LANE LINES AS MUCH AS POSSIBLE.
3. ALL CONFLICTING PAVEMENT MARKINGS TO BE ERADICATED.
4. PAVEMENT MARKINGS NOT TO BE INSTALLED THROUGH PEDESTRIAN CROSSING.
5. MT. LEBANON CRIME STOPPERS AND NO PARKING SIGN TO BE RELOCATED.
6. REFER TO SHEET 6 OF 11 FOR UNDERGROUND UTILITIES.

**S.R. 3033 REQUIRED PAVEMENT MARKINGS AND SIGNS**

SYMBOL	SERIES DESIGNATION	UNIT	LEGEND OF DESCRIPTION	QUANTITY
W/6"	0960-0005	LF	6" WHITE HOT THERMOPLASTIC PAVEMENT MARKINGS	264
W/24"	0960-0021	LF	24" WHITE HOT THERMOPLASTIC PAVEMENT MARKINGS	143
N/A	0963-0001	SF	PAVEMENT MARKING REMOVAL	300
	0960-0226	EA	WHITE HOT THERMOPLASTIC LEGEND, "THRU AND RIGHT ARROW", 20' - 0" X 7' - 0"	2
	0960-0224	EA	WHITE HOT THERMOPLASTIC LEGEND, "LEFT ARROW", 12' - 0" X 3' - 0"	2
	0960-0101	EA	WHITE HOT THERMOPLASTIC LEGEND, "ONLY", 8' - 0"	2
ⓐ	R3-8A	EA	LANE USE CONTROL SIGN (L-SPECIAL*) 30" X 30"	2

\* SEE DETAIL FOR MORE INFORMATION



Know what's below.  
Call before you dig.  
Serial No. 20200441945

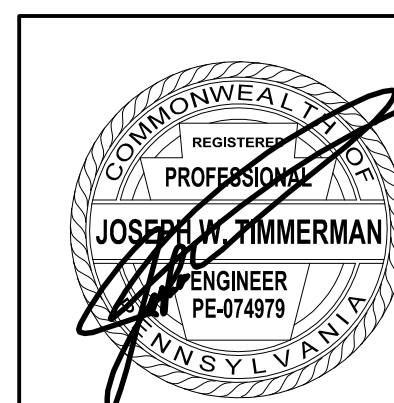
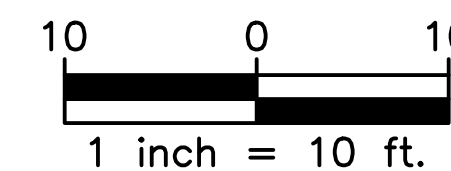

**GATEWAY**  
The Gateway Engineers, Inc.  
Full-Service Civil Engineering & Surveying  
Pittsburgh, PA  
gatewayengineers.com 855-634-9284

SIGNING AND PAVEMENT MARKING PLAN

S.R. 3033 (SEGAR ROAD)

Path & File: C:\Projects\97000 Mt. Lebanon\97244 Bower Hill & Segar Ave\97244-0000\_Signing and Pavement Marking Plan.dwg  
 Plot Date: 7/2/2020 8:25 AM Thomas J. Stronck Save Date: 7/2/2020 8:24 AM